

AFRO VILLAGE

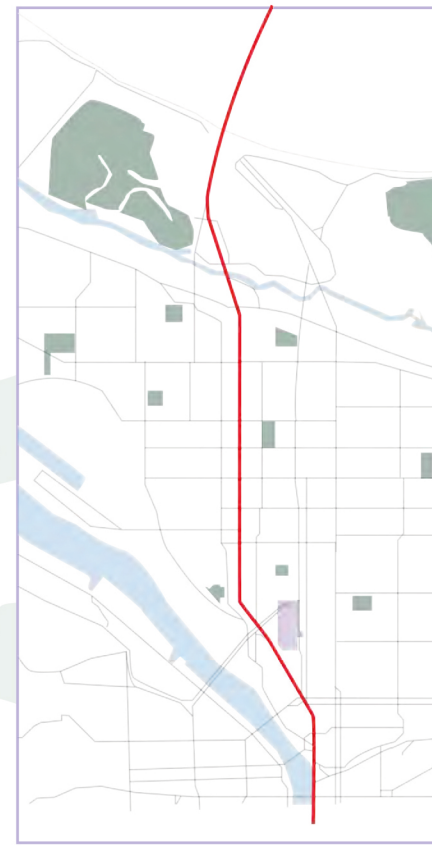

Historical Context

It's no big secret that housing policies in the United States have disproportionately affected black americans; especially in the Portland metropolitan area. The racial covenants and laws that made it effectively illegal to live in Oregon if you were black being one of the worst offenders. Black residents of Portland have been continuously displaced and unable to establish a long term home or multi-generational community whether it be through the environmental destruction of Vanport, the planned divestment in Albina, or the pricing out and rapid gentrification of North and Northeast. Reconciling these problems is at the forefront in the creation of a AfroVillage for black residents of Portland. In response to the houslessness crisis and continually growing unaffordability of our city, a culturally specific village can better serve those who are consistently failed by our current systems and solutions to this problem. Creating a community that can outlast more displacement and favor growth, sustainability, and independence evermore.



Potential Site Considerations

Site A : Urban



Site B : Vacated Business

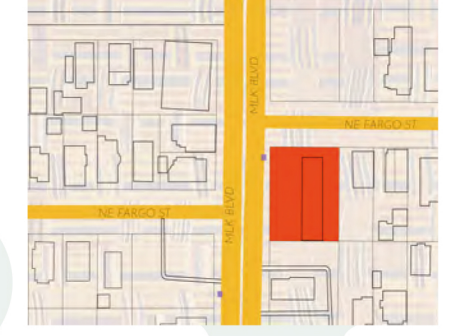

Site C : Pre-existing Infrastructure



Site D : Parking Garage

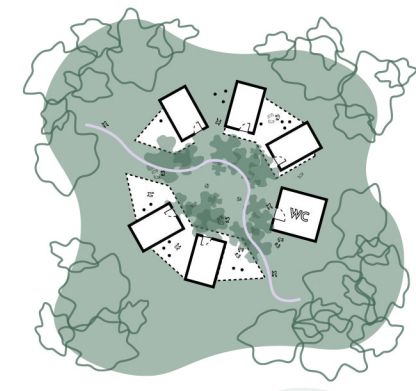

Communal Clusters

The proposed village is made up of four clusters, each cluster containing five housing pods and one shared composting toilet. The pods open to a central garden area that cluster residents share. Village paths will connect to the main pathway through each cluster. Each pod has a porch on it's left side and residents will have the option to build a "connector porch" on the right side which locks into their neighbor's porch to create a larger gathering space for the cluster. This connector porch can be built by residents or community members as a hands-on community engagement project that also gives residents a deeper sense of ownership within the village space.

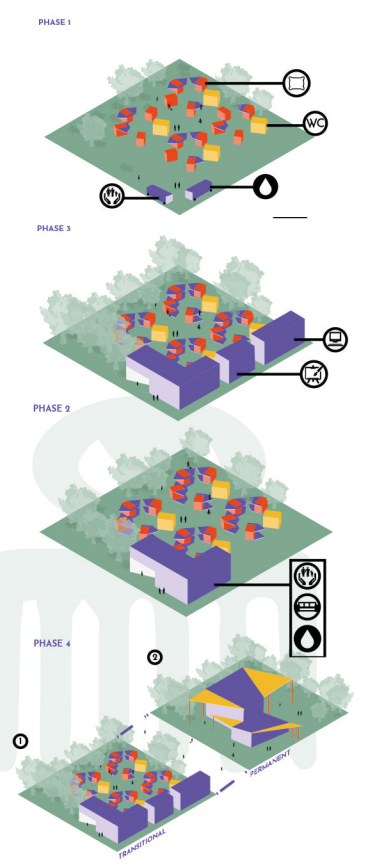

Pod Design

- Porches**
Historically significant African-American architectural components & flexible gathering spaces.
- Natural Lighting Strategies**
Clerestory lights around roof line in addition to windows with wooden louvers to give residents control over privacy and light needs.
- Artistic Customization**
Exterior walls can be painted and customized by residents to celebrate creative explorations by residents & community members.



Village Configuration

The AfroVillage design promotes healing, community-building, and future growth. The village is spa-like in it's connection to nature and emphasis on quiet, green space. Pods are arranged in clusters to create direct connections between residents. Porches are used throughout the village as community gathering spaces for residents and the community. Other notable community-centered moments within the design are a public laundromat, areas such as mural walls for creative collaboration, and a flexible community building.

